

NEW



Quality and reliability is our tradition

KYORITSU

PHASE INDICATOR KEW 8031/8031F

**Simple operation and ruggedness.
Check of open phase and phase
sequence are possible in one unit.**

**KEW 8031
(Standard type)**



* non compliant with CE

**KEW 8031F
(Fuse incorporated)**



**KEW 8031
(CE type)**



**Long selling models were renewed
with the design and the measurement category!**

• **Two Functions in One Unit**

Presence of open phase can be checked by the lamps, and the phase sequence can be indicated by the rotating disk.

• **High Reliability**

Wide measuring range for 3-phase installations from 110V to 600V. Sealed against dust ensures the trouble-free performance.

• **Battery-free tester**

KYORITSU ELECTRICAL INSTRUMENTS WORKS, LTD.

www.kew-ltd.co.jp

Simple operation

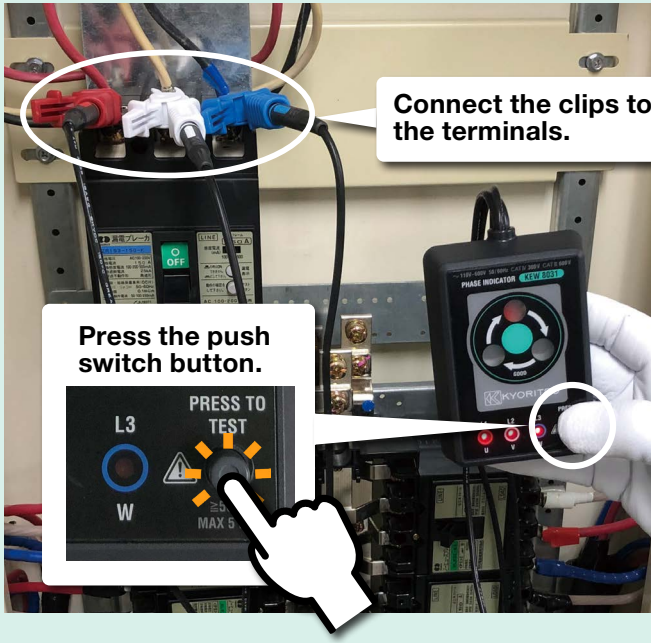

Two functions in one unit

Phase check with three lamps.

OK

open phase

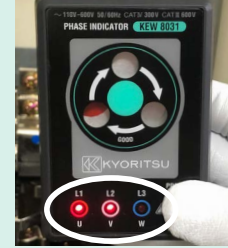

Sequence check with rotating disk.

Positive phase (clockwise)

Reversed phase (counter-clockwise)

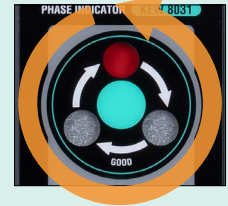
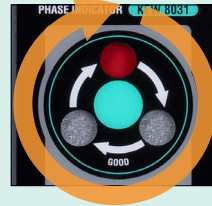

KEW 8031/8031F Specifications

| | KEW 8031 (Standard Type) | KEW 8031 (CE Type) | KEW 8031F (Fuse incorporated) |
|---------------------------|--|---|---|
| Appearance | | | |
| Operational voltage | 110 - 600V AC (50/60Hz) | | |
| Time limit for continuous | >500V: within 5 minutes | | |
| Fuse | - | | 0.5A/600V (F) |
| Applicable standards | - *non compliant with CE | IEC 61010-1 CAT IV 300V, CAT III 600V Pollution degree 2 | |
| Dimensions | 106(L) × 75(W) × 40(D)mm | | |
| Weight | 350g approx. | | |
| Cord | 1.5m (R: red S: white T: blue) | | |
| Accessories | 9029 (Carrying Case) Instruction manual | | 8923 (Fuse[0.5A/250V])* 9094 (Carrying Case) Instruction Manual |

*included

Accessories



9029 (Carrying Case)



9094 (Carrying Case)



8923 (Fuse) *8031F



Safety Warnings :

Please read the "Safety Warnings" in the instruction manual supplied with the instrument thoroughly and completely for correct use. Failure to follow the safety rules can cause fire, trouble, electrical shock, etc. Therefore, make sure to operate the instrument on a correct power supply and voltage rating marked on each instrument.

■ For inquires or orders :



**KYORITSU ELECTRICAL
INSTRUMENTS
WORKS, LTD.**

2-5-20, Nakane, Meguro-ku, Tokyo, 152-0031 Japan

Phone:+81-3-3723-0131

Fax:+81-3-3723-0152

E-mail:info-eng@kew-ltd.co.jp

www.kew-ltd.co.jp

